



spacious home with modern styling



Thorverton Single Lodge

BUILDING A BRIGHTER FUTURE



PATHFINDER PARK HOMES
Cavalier Road, Heathfield, Newton Abbot, Devon TQ12 6FJ

Telephone: 01626 833 799 Email: sales@pathfinderhomes.co.uk

www.pathfinderhomes.co.uk

www.pathfinderhomes.co.uk



Thorverton Single internal layout

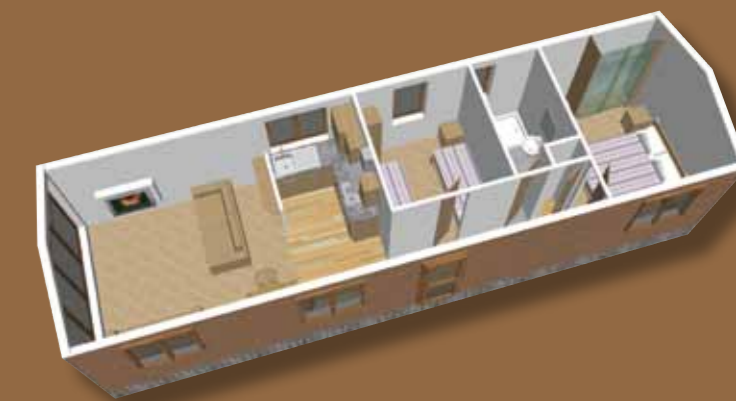

Spacious home with modern styling

Inspired by the success of its larger twin sister, the Thorverton Single is a deceptively spacious home with modern styling, ideal for those park owners thinking about replacing static caravans with lodges.

Finished with panache and fine quality furnishings, the two bedroom Thorverton has luxurious features

throughout and is flooded with natural light thanks to the eye-catching floor to ceiling glass wall at the end of the living space.

An impressive home with contemporary open-plan living space, wall mounted flat screen TV and stylish shower room. The Thorverton is luxurious yet budget friendly!

Available sizes

38' x 12' - 2 Bedroom

40' x 12' - 2 Bedroom

44' x 12' - 2 Bedroom

45' x 12' - 2 Bedroom

Custom sizes and layouts can be designed on request

Interior colours



Thorverton Single Scheme 1



Thorverton Single Scheme 2



Thorverton Single Scheme 3



Thorverton Single Lodge features

- Low maintenance Thermo wood cladding or CanExcel cladding
- Feature panoramic lounge windows
- French doors and fully glazed gables
- UPVC windows, doors, fascias and soffits
- Soffit lights on overhang roof
- Built to residential BS3632 standards
- Tongue and groove style high pitch vaulted ceiling
- Light and well equipped open-plan living area
- Wall mounted flat screen TV
- Fully equipped kitchen, featuring dishwasher, fridge/freezer, gas hob, extractor and electric oven
- Two bedrooms
- Twin beds in bedroom two
- Shower room with modern, ceramic basin and heated towel rail